

COMMUNITY PROGRAM LAUNCH DURING FIFA WORLD CUP 2026

Future Arts Way Seattle's Digital District

Launch Pad Locations:

Pioneer Square Preservation District



Presented by



A 2.5 mile interactive path through Downtown Seattle highlighting underrepresented businesses & emerging arts centers

- VINYL "AR" LAUNCHPAD : on Sidewalk and Windows
- Immersive AR Experience at each stop
- No downloads - Web Based Platform w/ Mobile First Design.
- Google Maps Integration for easy path
- Fully Curated Tour Experience with up to 25 stops
- Link Outs + Sponsor Integrations
- Leveraging the [City Wayfinder Platform](#), powered by [Houdini](#)

Click to Try the [Pilot Future Arts Wayfinder](#)

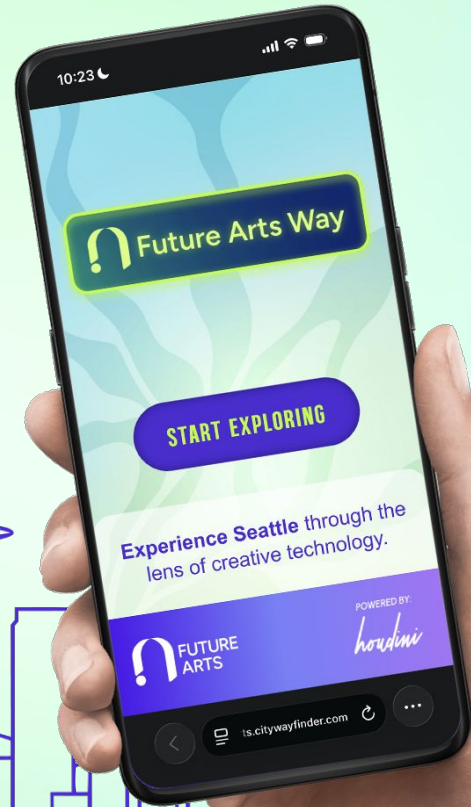



Future Arts Presents: Other Earth 2026 | Artist Collective

Future Arts Way: Other Earth 2026 is a collaborative, artist-led initiative that centers the voices, knowledge, and creative expression of local and regional artists, with a particular emphasis on Coast Salish communities. A core component of the project is the Currents Cohort, a collective of Coast Salish artists, knowledge holders, storytellers, and cultural practitioners who have come together to explore Indigenous storytelling through augmented reality and public art. Through a series of gatherings, the cohort has shared stories, mapped salmon journeys through the Salish Sea, and co-created visions rooted in ecological stewardship and cultural continuity.

The project features contributions from a diverse group of Indigenous artists representing communities such as the Suquamish, Swinomish, Lummi, Snoqualmie, Makah, Chehalis, Muckleshoot, and Jamestown S’Klallam, whose work reflects deep relationships to land, water, and ancestral knowledge through motifs like salmon and plant medicine. In addition, multidisciplinary artists such as Divine Ndemeye contribute plant-based healing symbologies that introduce a complementary “flora” dimension to the visual system. Together, these artists create a unified, site-responsive visual language that blends Indigenous knowledge, Afrofuturism, and Pacific Northwest ecologies, grounded in a collaborative, consent-based process that ensures cultural integrity and artist involvement throughout.

We have also worked closely with businesses and organizations located along the Future Arts Way trail, engaging them directly in the process and securing their agreement to host installations and be featured as part of the experience. This collaborative approach ensures that the project is not only artist-centered but also community-supported, strengthening connections between creative expression, place, and the local Pioneer Square district.

Meet the Artists



Divine Ndemeye (she/her)
Parasitic Bath & Waterfall
+ Bath - Artist



Alina Nazmeeva (she/her)
Currents AR Salmon Run Artist



Alex Kosnett (they/them)
Currents AR Salmon Run Ecologist



Alexis Eggertsen (she/her)
Multimedia Artist & Music Director



Future Arts Way

THE PATH

Small Business + Arts & Cultural Spaces

Future Arts Way - 2026 MAP

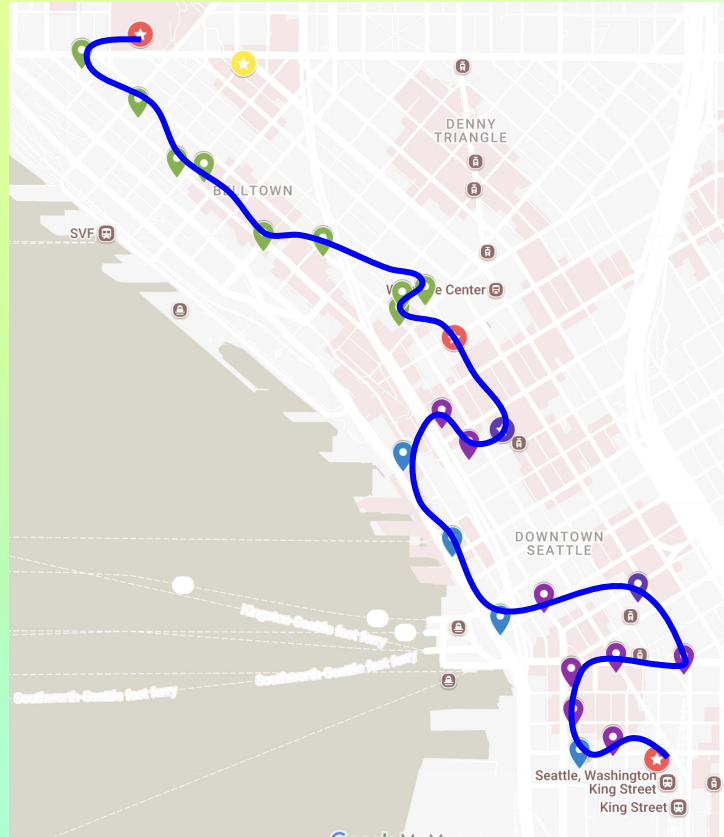

- ✓ Future Arts Way: NORTH ROUTE
- Individual styles
- ★ (1) Pac Sci ARCHES ✓
- ★ Chief Seattle Statue (Special...)
- 📍 (2) Noir Lux Candle Bar ✓
- 📍 (3) Labour Temple ✓
- 📍 Common Objects ✓
- 📍 Lenox ✓
- 📍 Mixed Pantry ✓
- 📍 Common Area Maint. ✓
- 📍 Base Camp Studios 2 ✓
- 📍 WeRise Wines ✓
- 📍 Orcas Paley ✓
- ★ 3rd Ave & Pine Midway ✓

- ✓ Future Arts Way: SOUTH ROUTE
- Individual styles
- ★ Benaroya Hall ✓ (Ivan)
- 📍 SAM Shop & Gallery ✓
- 📍 Eighth Generation
- 📍 Family - QWALSUIUS- SHAUN ...
- 📍 "Looking At All Tomorrows 2..."
- 📍 Honoring Our Muckleshoot ...
- 📍 The Shop - LMN Architects ✓
- 📍 Dan's Artwork - 651 4th Ave ✓
- 📍 Actualize Space ✓
- 📍 the Metropole
- 📍 Avery Barnes Gallery ✓
- 📍 ANTIPODE Art Gallery
- 📍 RailSpur - Alley ✓
- 📍 The Lemon Grove ✓
- ★ ARTS ✓

"ARCHES TO CLOCK TOWER"

A 2.5 Mile Interactive Path Featuring Underrepresented Community Business & Emerging Arts Orgs

- 3 Trailheads with larger AR installations
 - North Trailhead - Seattle Center
 - Midway Trailhead - 3rd & Pine
 - Special Stop at Benaroya Hall
 - South Trailhead - Office of Arts & Culture

- 25 "Vinyl Launch Pad" Stops containing:
 - Floor Vinyl (or window vinyl) with QR code
 - Augmented Reality Activation
 - Partner Business - at no cost to the business

[Click here for Google Map](#)

THE VINYL AR LAUNCHPADS “Drops”

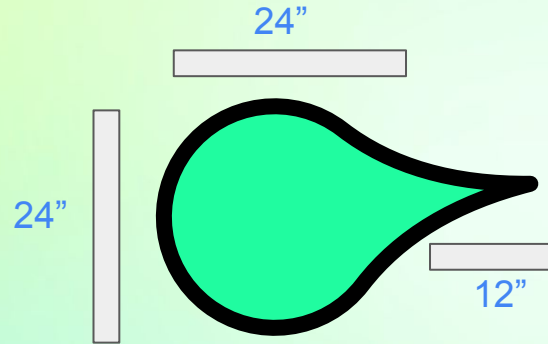

Main Drop Sizing
34" long X 24" Wide

35 to be installed at **27** locations

Note: This was the best design to accommodate average foot sizing and our extra thin compass system on the edge.

Anatomy of A Launch Pad Drop

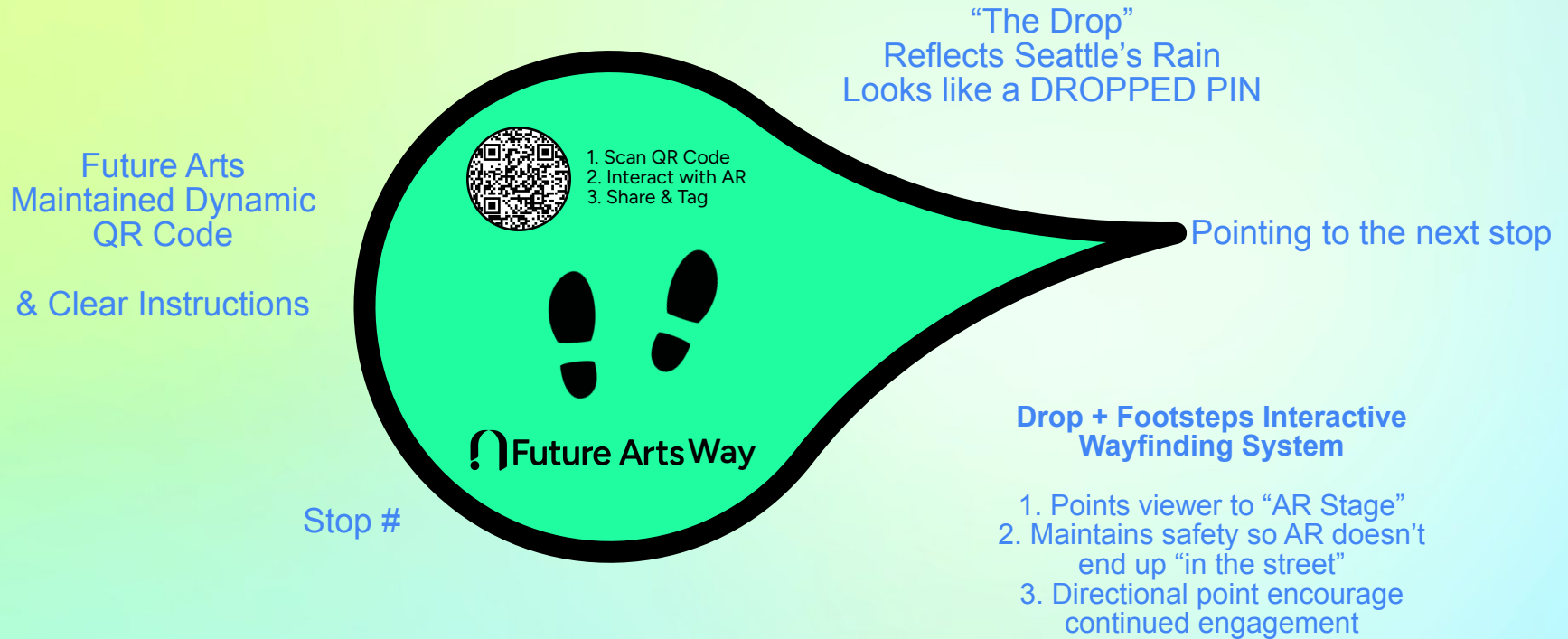

Versatile Design of Launch Pad Drop

SCHEDULE

- Will be installed by May 31st
- Uninstalled & Recycled by December 31

MAINTENANCE

Managed Bi-weekly by Future Arts Ambassadors + our partners at DSA to ensure any vandalism is reported and new drops installed.



The Material & Install Partner



superGraphics

ecoformat™

AlumiGraphics GRIP

Key Features and Benefits

- **Surface Conformity:** The aluminum substrate fits into grout lines and textured surfaces like brick, concrete, stucco, and asphalt.
- **No Over-laminate Needed:** Direct print technology makes production faster and cheaper.
- **Easy Installation/Removal:** A simple peel-and-stick process that does not require heat guns, allowing for easy application by non-professionals.
- **Durability:** Lasts up to 24 months for outdoor, exterior wall applications, and handles heavy pedestrian traffic.
- **Eco-Friendly:** Contains no PVC or hazardous ingredients; it can be recycled with other aluminum waste.
- **Safety Standards:** Complies with ASTM, ISO, and OSHA standards for slip resistance.



Future Arts Way

THE PATH

Small Business + Arts & Cultural Spaces

South Route Stop

Actualize Space

Address: [112 Prefontaine Pl S Seattle, WA 98104](https://www.actualizespace.com/)

Actualize Space is an artist-led venue focused on process-driven, socially engaged work. Through exhibitions and programming, it nurtures emerging voices and fosters dialogue around contemporary issues.

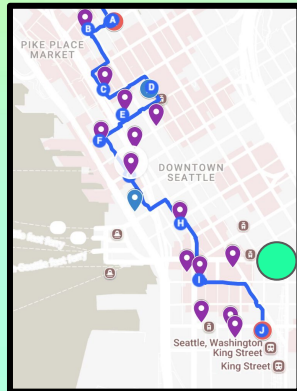

2025-2026

Actualize Space

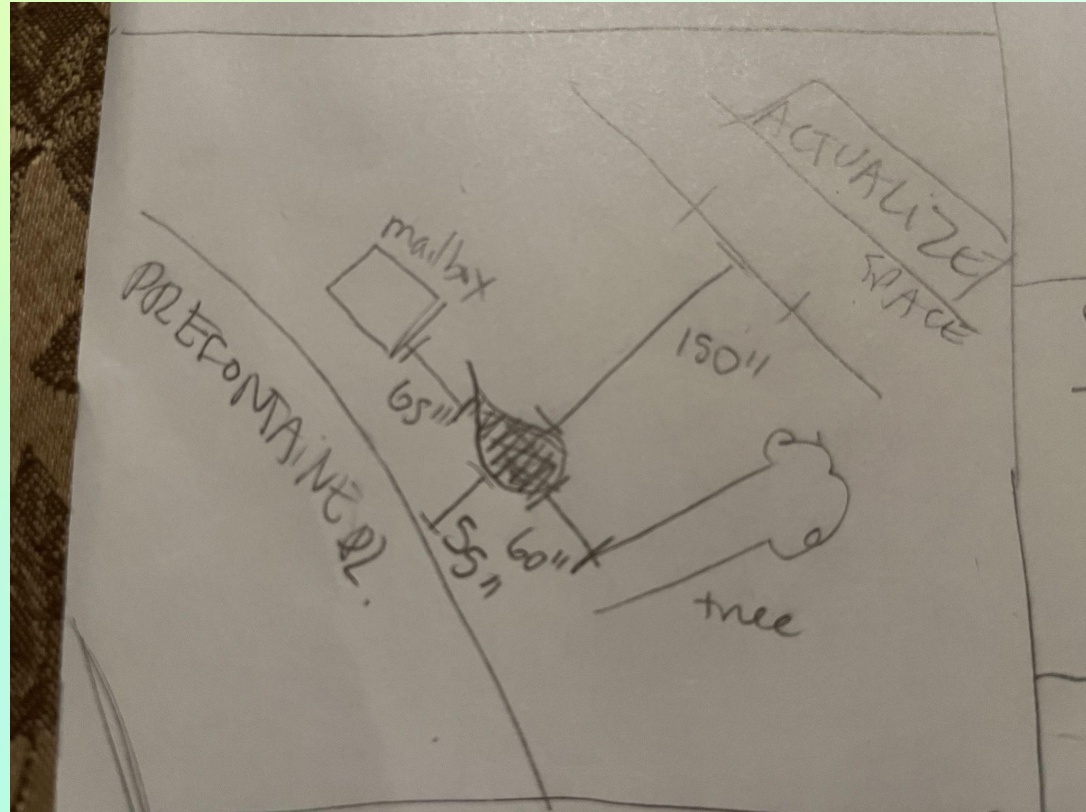

South Route Stop

Actualize Space



Type of Drop



AR Stage Background

2025-2026

South Route Stop

Arundel Books

Address: [322 1st Ave S Seattle, WA 98104](#)

Arundel Books is an independent, family-owned bookstore in Pioneer Square specializing in rare, used, and out-of-print books. Known for its curated collection and literary focus, it serves as a longstanding cultural and intellectual hub within Seattle's historic district.

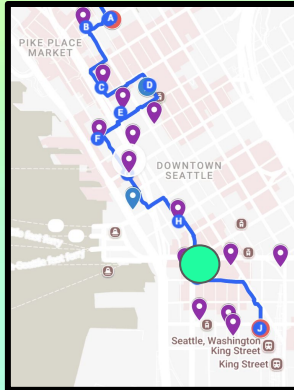

South Route Stop

Arundel Books

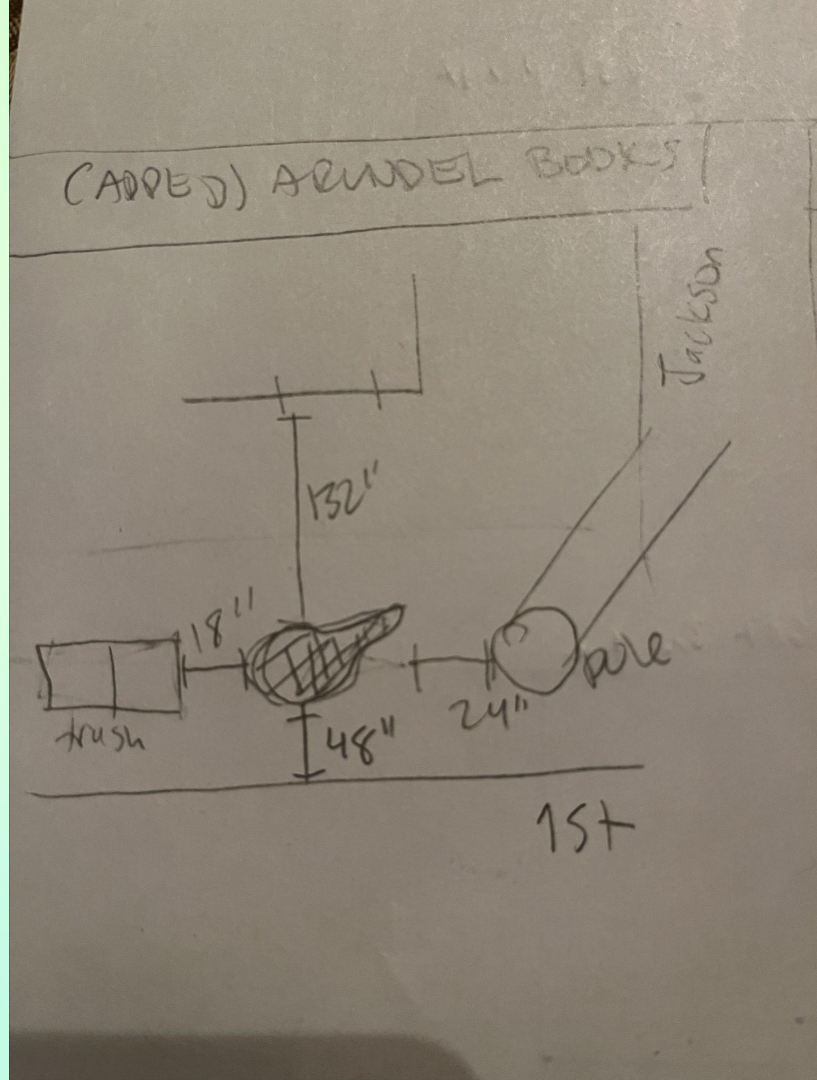

South Route Stop

Arundel Books



Type of Drop

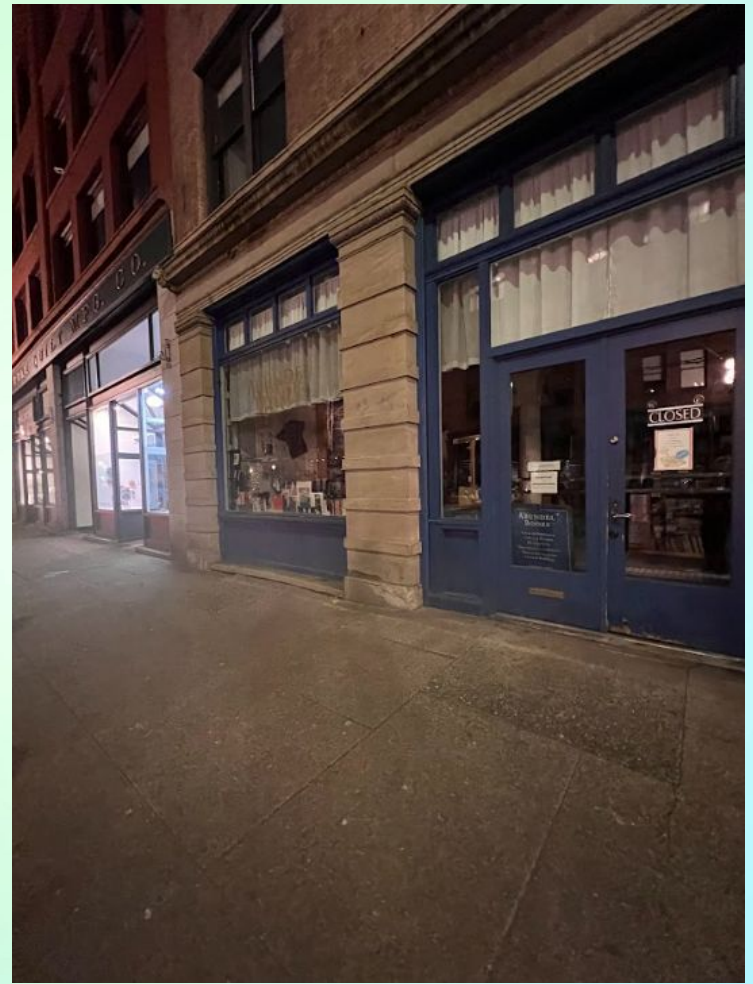

AR Stage Background

2025-2026

South Route Stop

ANTIPODE Gallery

Address: [103 South Main St Seattle, WA 98104](#)

Antipode Gallery is an experimental exhibition space that champions boundary-pushing contemporary art. It provides a platform for innovative practices that challenge conventional forms and ideas.

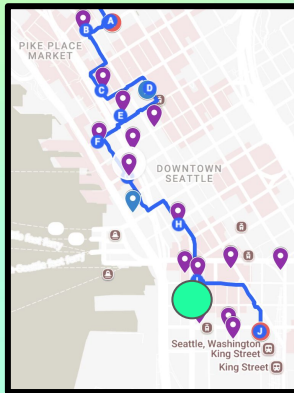

South Route Stop

ANTIPODE Gallery

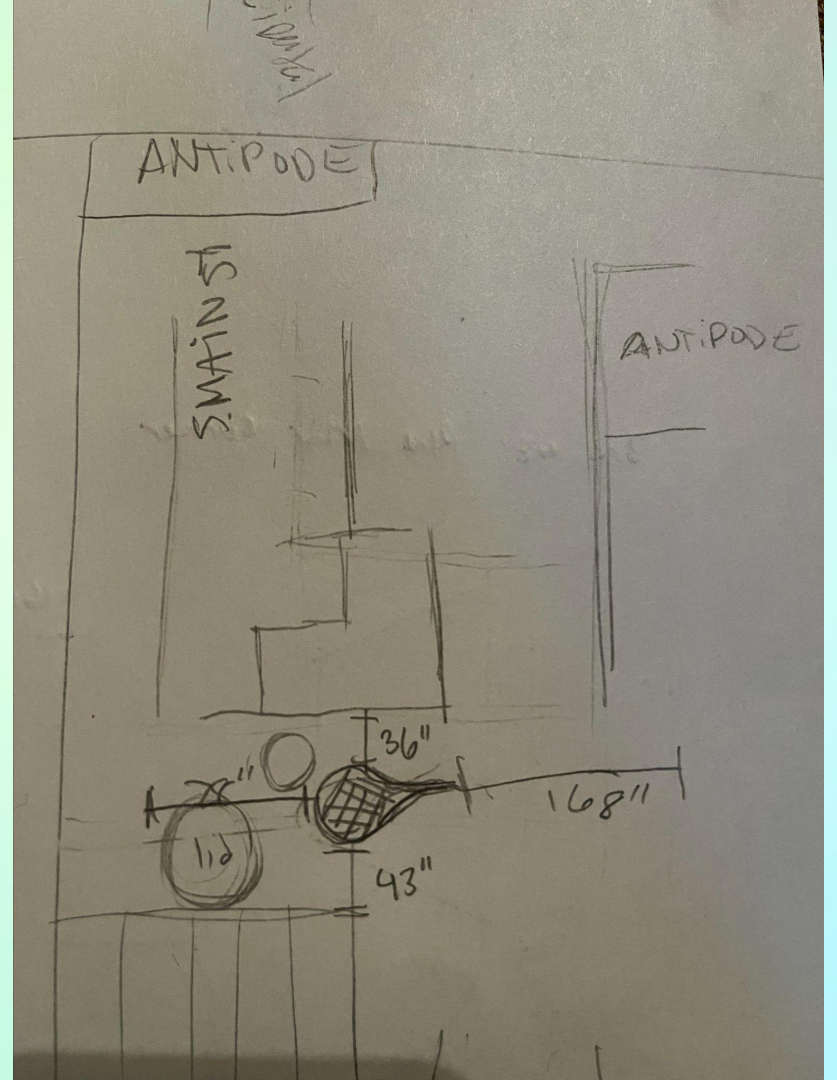

South Route Stop

Frida

Address: [113 1st Ave S, Seattle, WA 98104](https://www.frida-seattle.com/)

Frida is a Latina owned boutique curated with intention, bringing together rare vintage finds that complement the modern woman's wardrobe. Their pieces aren't just clothes, they are stories waiting to be continued, treasures that have stood the test of time, ready for their next chapter.

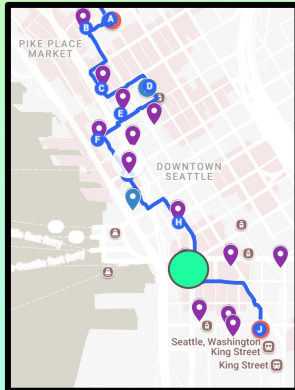

2025-2026

Frida

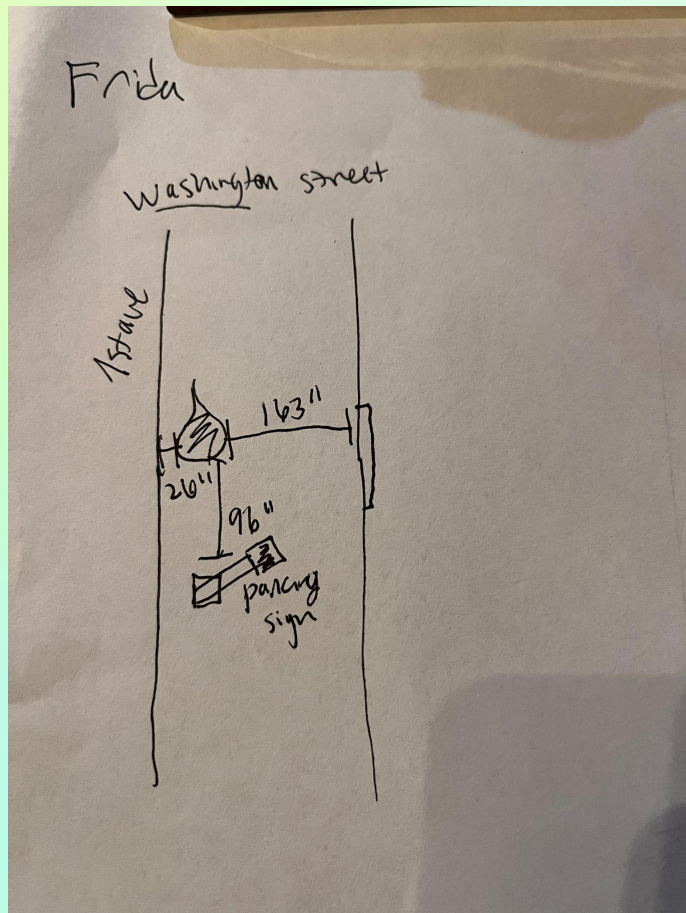

South Route Stop

Frida



Type of Drop



AR Stage Background

2025-2026

South Route Stop

651 4th Ave (2 drops)

Address: [651 4th Ave Seattle, WA 98104](#)

651 4th Ave is a downtown address embedded within Seattle's civic and commercial core. Its location situates it among key institutions, transit corridors, and evolving urban development.

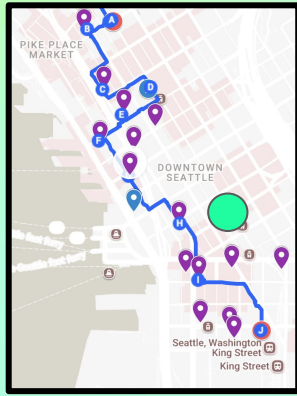

South Route Stop

651 4th Ave

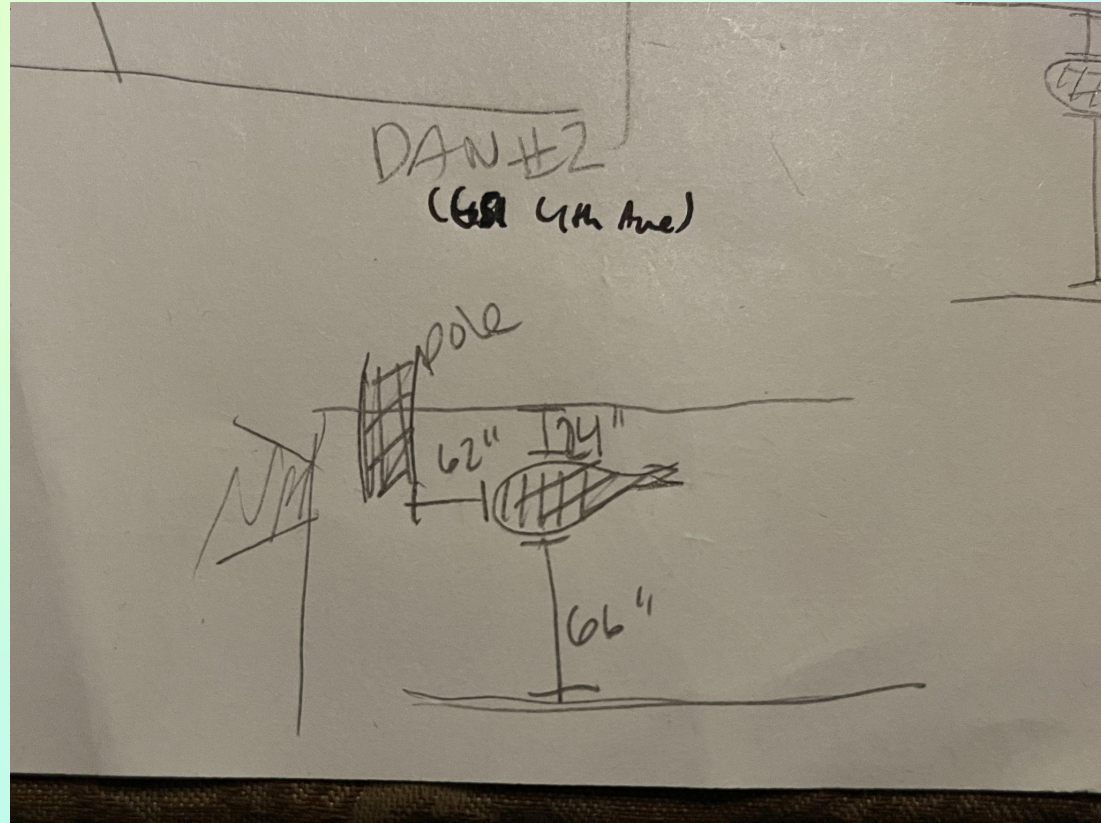
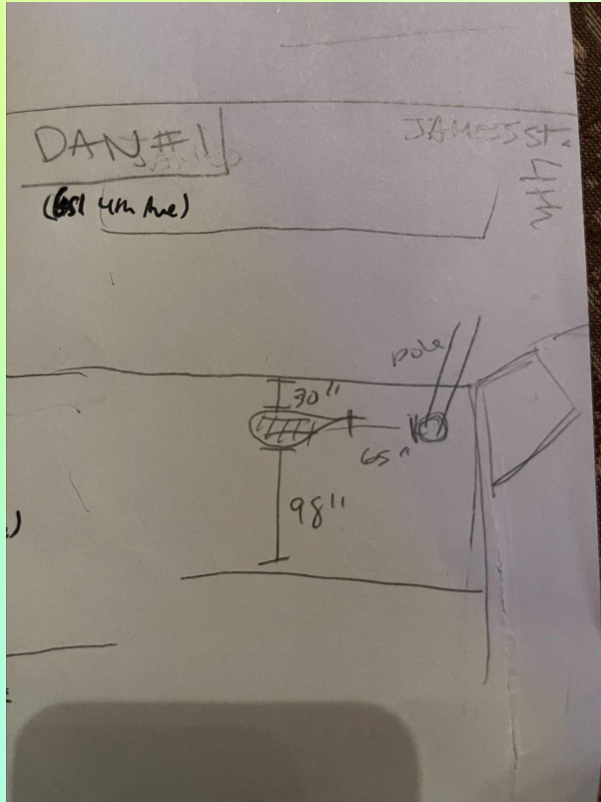

South Route Stop

651 4th Ave



Type of Drop



2025-2026

AR Stage Background

South Route Stop

Lemon Grove

Address: [165 S Jackson St Seattle, WA 98104](#)

The Lemon Grove (also known as Lucky Lemons) is a hybrid café, bar, and creative venue that brings together food, art, and community. It functions as both a social gathering space and a platform for cultural programming.

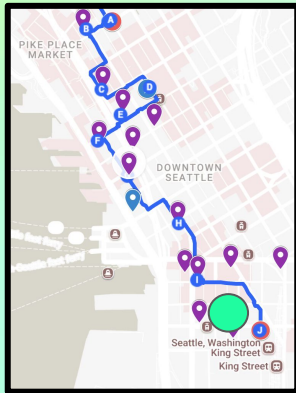

Lemon Grove

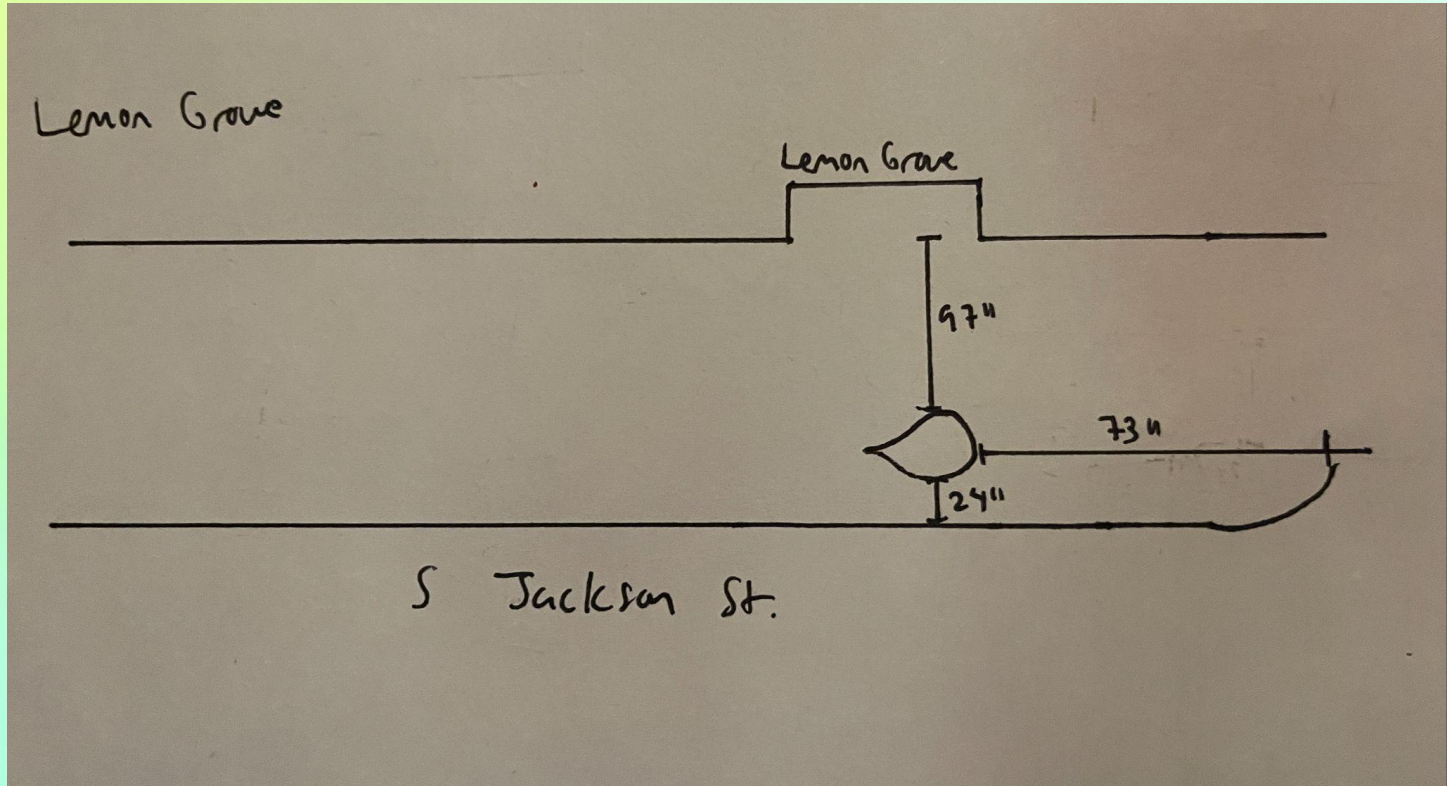

South Route Stop

Lemon Grove



Type of Drop



AR Stage Background

2025-2026

South Route Stop

The Metropole

Address: [423 2nd Ave Ext S Seattle, WA 98104](#)

The Metropole is a dynamic, multidisciplinary space that brings together performance, visual art, and community events. It serves as a gathering point for creative exchange and cultural experimentation.

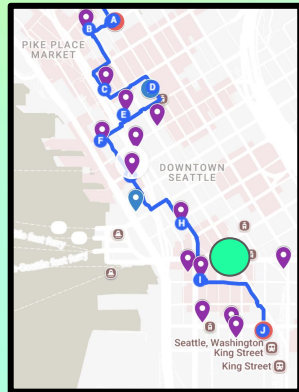

South Route Stop

The Metropole

Address: [423 2nd Ave Ext S Seattle, WA 98104](#)

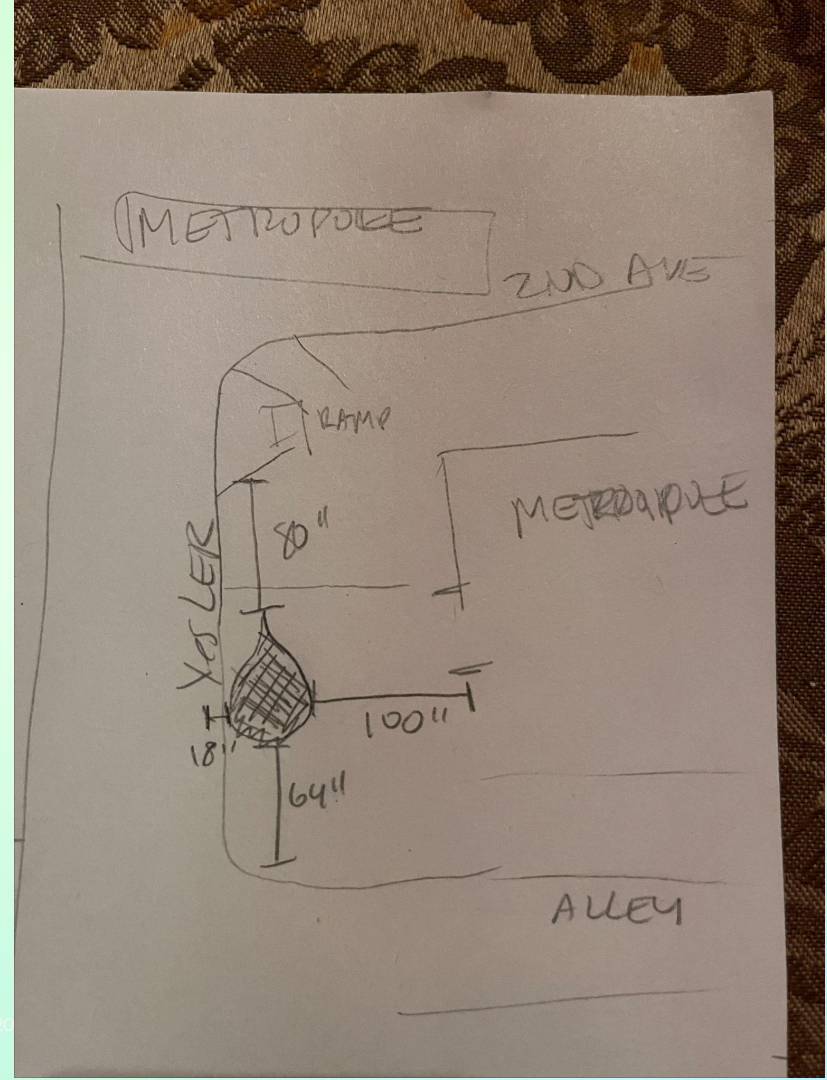

South Route Stop

The Metropole



Type of Drop

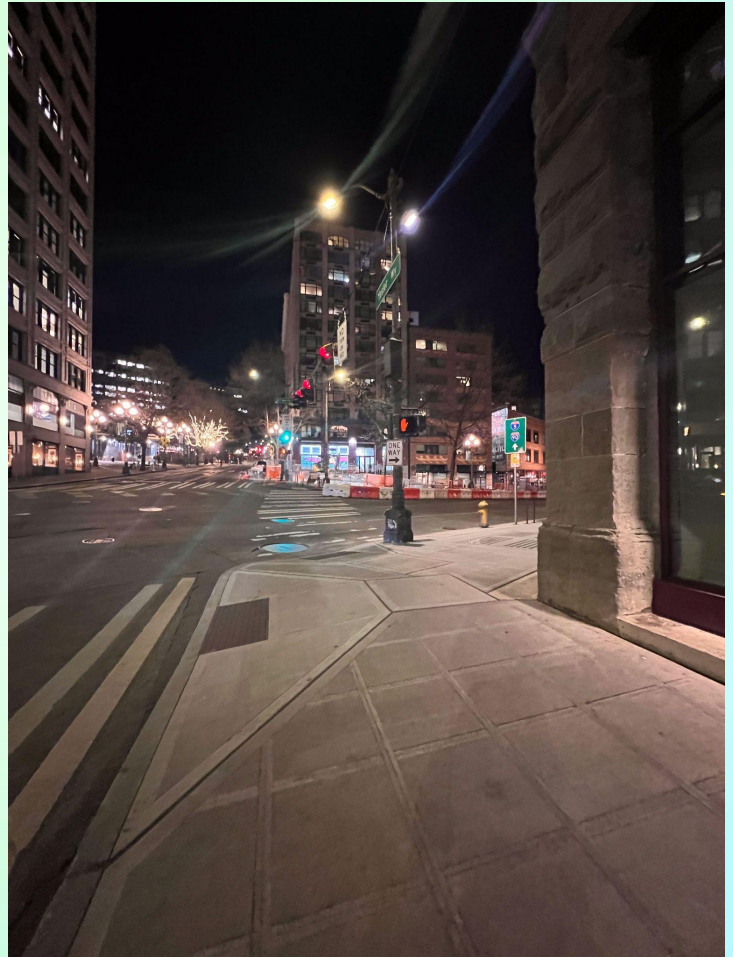

2025-2026

AR Stage Background

South Route Stop

RailSpur Alley

Address: [115 S Jackson St Seattle, WA 98104](https://www.google.com/maps/place/115+S+Jackson+St+Seattle,+WA+98104)

RailSpur Alley is a vibrant pedestrian alley in Pioneer Square that serves as a hub for local art, small businesses, and cultural events. Known for its historic character and creative energy, it activates the district through community programming, public art, and unique retail experiences.

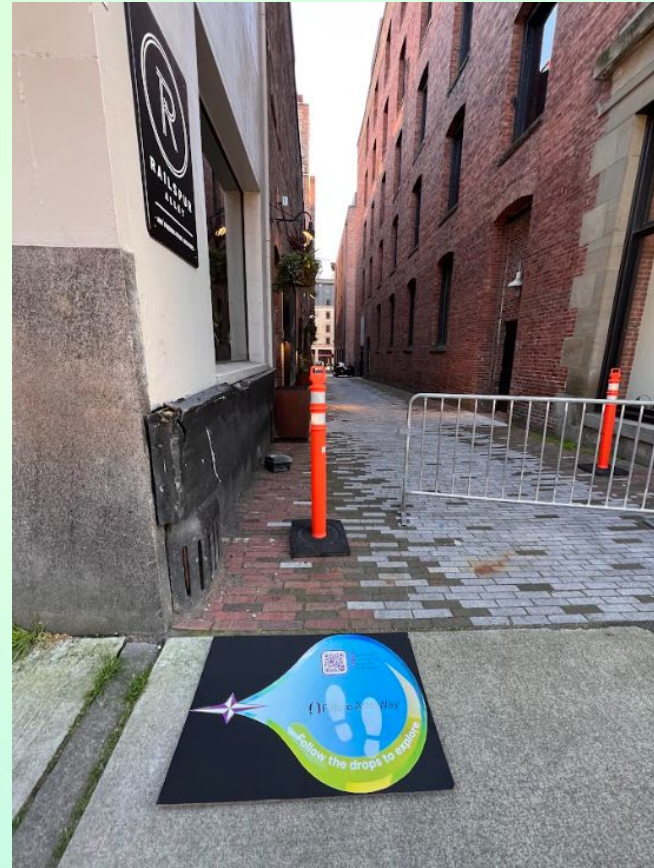
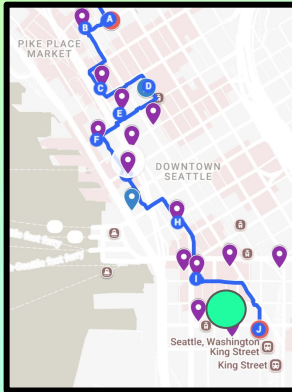

2025-2026

South Route Stop

RailSpur Alley

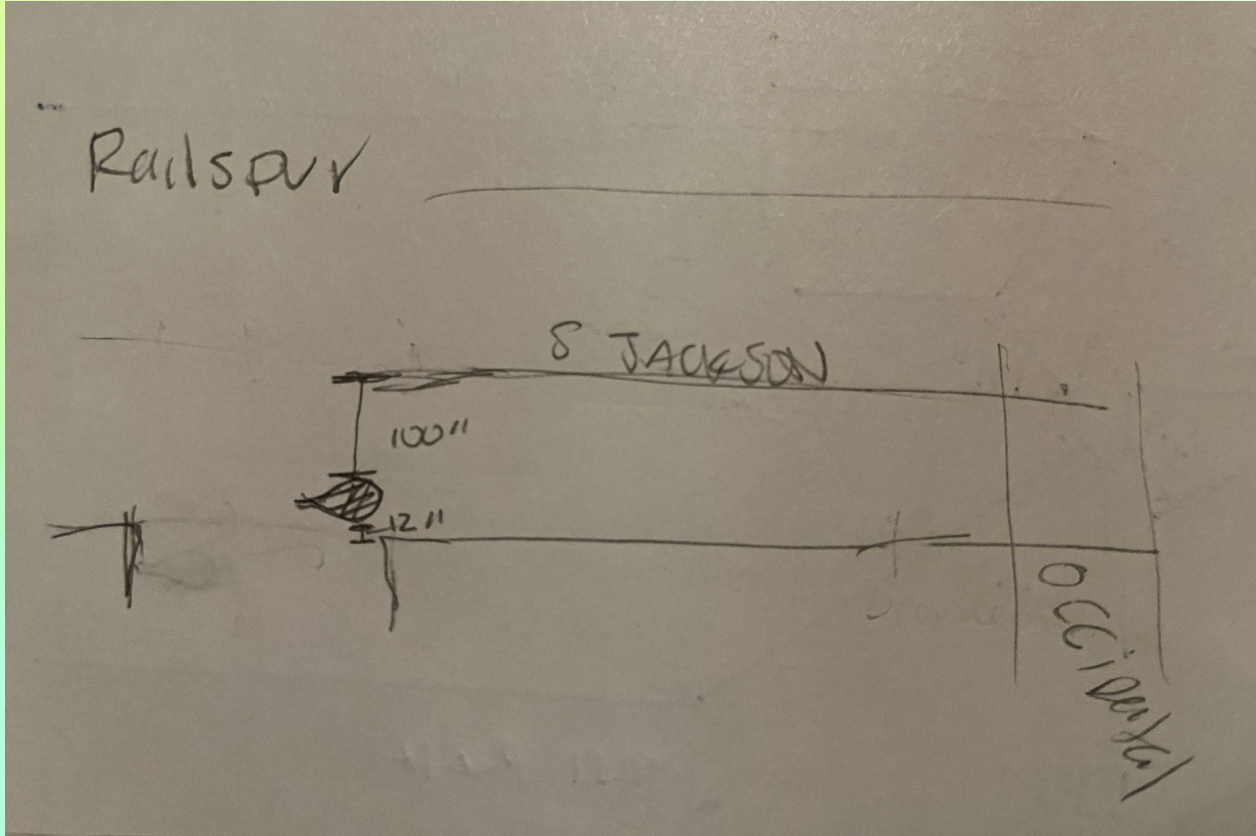

South Route Stop

RailSpur Alley



Type of Drop

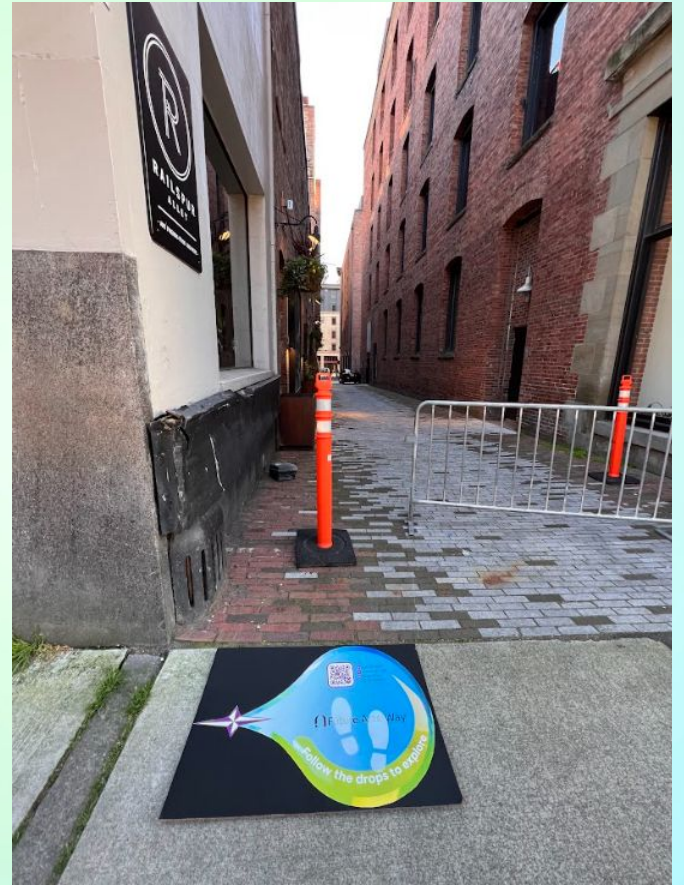

AR Stage Background

2025-2026

South Route Stop

The Shop - LMN Architects

Address: [723 1st Ave Seattle, WA 98104](https://www.lmnarchitects.com/locations/the-shop)

LMN Architects internal fabrication and prototyping space, known as "The Shop," supports material experimentation and design innovation. It allows architects and designers to test ideas physically, bridging conceptual work with hands-on making.

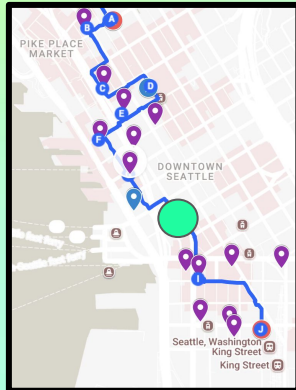

2025-2026

South Route Stop

The Shop - LMN Architects

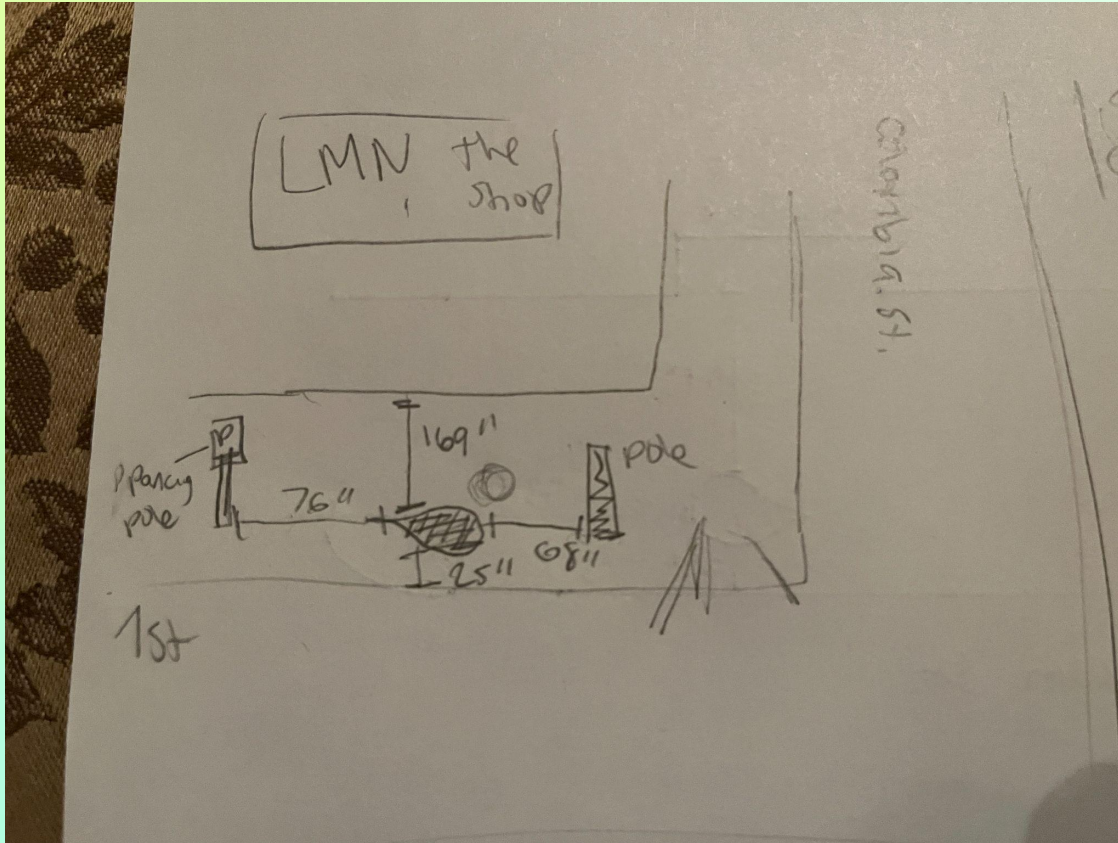

South Route Stop

The Shop - LMN Architects



Type of Drop

2025-2026

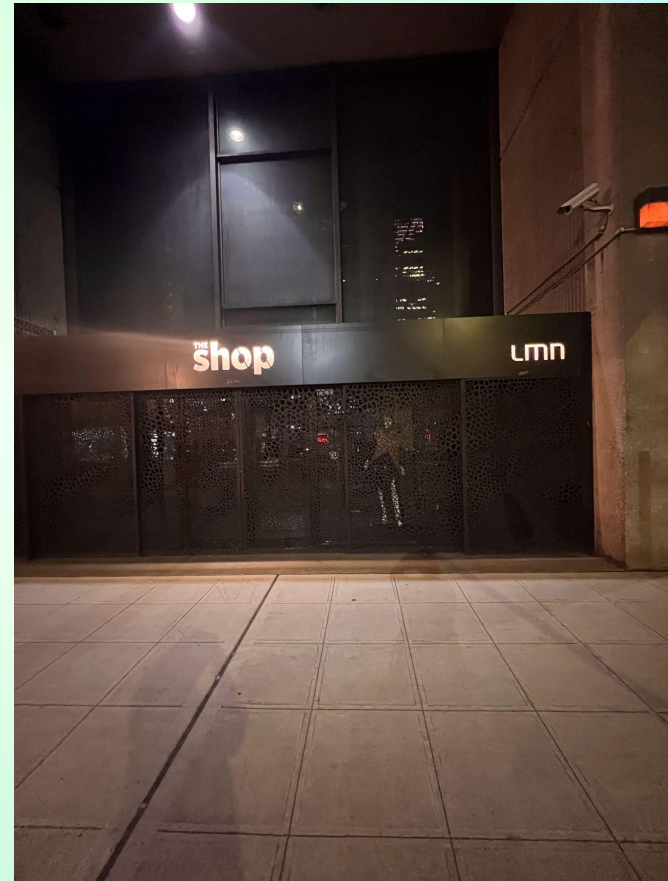

AR Stage Background